



DELTA SAMA JAYA SDN. BHD. (DSSB)

Reg. No: 199901025376 (500276-W)

(Registered with Ministry of Finance, Tenaga Nasional Berhad (TNB), CIDB, KTMB, Telekom (TM), etc.)

HIGH QUALITY CABLE SLAB & MARKERS



**23G & 23M , DSSB Building, Jalan Perdana 6/8, Pandan Perdana
55300, Kuala Lumpur, Malaysia.**

Tel: +603-9282 4007, +603-9281 3778 ; Fax: +603-9287 0705

Email: samajaya@substation.com.my

Email: sales@substation.com.my

Website : www.substation.com.my

Website: www.cableslab.com



Redefining Supply
An ISO 9001:2015 &
14001:2015 Company

DELTA SAMA JAYA SDN. BHD. (DSSB) (Reg. No: 500276-W)

No. 23G & 23M, DSSB Building, Jalan Perdana 6/8, Pandan Perdana,
55300 Kuala Lumpur, Malaysia

Tel: +603-92824007, +603-92813778 Fax: +603-92870705

Email: (HQ): samajaya@substation.com.my, (Sales): sales@substation.com.my

Website: www.substation.com.my, www.cablecleat.com.my

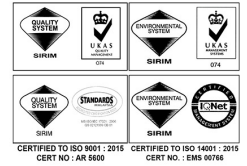

HIGH QUALITY SLABS / TILES (TRIPLE / SINGLE HOOK)

Introduction

Cable Slabs/Cover are used as visual warning indicators for cables laid underground, while at the same time provides mechanical protection for underground laid cables in the event of excavation work. The Cable Slab/Cover are buried below the ground level and above the underground cables.

Advantages

- Very high impact strength properties to provides good mechanical protection for underground laid cables and pipes.
- Very lightweight- reduce risk of personal injury.
- Designed for easy transportation.
- Designed with interlocking end (hook and slot) to make simple and effective connection at site.
- Can be supplied in any colour and language, identifying the type of services buried below.
- Prevent or minimise damages to Electrical Cables, Telecommunication Cables, Signalling Cables, Fibre Optic Cables, Gas Pipes, Water Pipes, etc.
- High impact resistant
- Reduce the cost for repairing
- Accidental dropping does not damage cables
- No risk of accidental breakages
- Maintenance free
- Gives the clearest warning
- Environmental Friendly

Marking and Embossing

The slabs shall be embossed with lettering to provide visual warning during excavation works and permanently marked as per customer's requirements.

Note

Various feedback from sites and customers indicated that, conventional type single hook/slot interlocking slabs/covers easily disconnected/break from the next slab/cover due to only one single hook and slot system. Our Cable Slab is designed and improvised with 3 hooks/slots to withstand 3 times the pulling force and do not come off or break during excavation work or during installation.



6mm thick
(Triple Hook)



Redefining Supply
An ISO 9001:2015 &
14001:2015 Company

DELTA SAMA JAYA SDN. BHD. (DSSB) (Reg. No: 500276-W)

No. 23G & 23M, DSSB Building, Jalan Perdana 6/8, Pandan Perdana,
55300 Kuala Lumpur, Malaysia

Tel: +603-92824007, +603-92813778 Fax: +603-92870705

Email: (HQ): samajaya@substation.com.my, (Sales): sales@substation.com.my

Website: www.substation.com.my, www.cablecleat.com.my

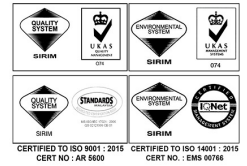

HIGH QUALITY CABLE SLABS/TILES (TRIPLE HOOKS)

(Thickness: 6mm)

| Item Code | Size (mm) | Colour |
|--------------------|-----------------------------------|-----------|
| DSSB-CSAP250Y-3-6 | 250mm(W) x 1000mm (L) x 6.0mm (T) | Yellow |
| DSSB-CSAP250O-3-6 | 250mm(W) x 1000mm (L) x 6.0mm (T) | Orange |
| DSSB-CSAP250G-3-6 | 250mm(W) x 1000mm (L) x 6.0mm (T) | Green |
| DSSB-CSAP-250C-3-6 | 250mm(W) x 1000mm (L) x 6.0mm (T) | Customize |



Laying of Protection Cover for gas pipe



Laying of fine Sand (covering the gas pipe)



Laying of Gas Pipe



**Now you can customize
your own colour &
wordings!!!
Call: +603- 9282 4007**



Redefining Supply
An ISO 9001:2015 &
14001:2015 Company

DELTA SAMA JAYA SDN. BHD. (DSSB) (Reg. No: 500276-W)

No. 23G & 23M, DSSB Building, Jalan Perdana 6/8, Pandan Perdana,
55300 Kuala Lumpur, Malaysia

Tel: +603-92824007, +603-92813778 Fax: +603-92870705

Email: (HQ): samajaya@substation.com.my, (Sales): sales@substation.com.my

Website: www.substation.com.my, www.cablecleat.com.my

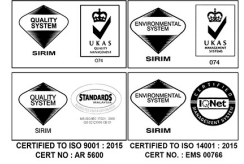

HIGH QUALITY CABLE SLABS/TILES (TRIPLE HOOKS)

(Thickness: 2mm)

| Item Code | Size (mm) | Colour |
|---|----------------------------------|--------|
| DSSB-CSAP-250O-3-2 | 250mm(W) x 1000mm (L) x2.0mm (T) | Orange |
| DSSB-CSAP-250G-3-2 | 250mm(W) x 1000mm (L) x2.0mm (T) | Green |
| DSSB-CSAP-250Y-3-2 | 250mm(W) x 1000mm (L) x2.0mm (T) | Yellow |
| DSSB-CSAP-250R-3-2 | 250mm(W) x 1000mm (L) x2.0mm (T) | Red |
| Other size/colour please call for enquiry | | |



**Now you can customize
your own colour &
wordings!!!
Call: +603- 9282 4007**





Redefining Supply
An ISO 9001:2015 &
14001:2015 Company

DELTA SAMA JAYA SDN. BHD. (DSSB) (Reg. No: 500276-W)

No. 23G & 23M, DSSB Building, Jalan Perdana 6/8, Pandan Perdana,
55300 Kuala Lumpur, Malaysia

Tel: +603-92824007, +603-92813778 Fax: +603-92870705

Email: (HQ): samajaya@substation.com.my, (Sales): sales@substation.com.my

Website: www.substation.com.my, www.cablecleat.com.my



HIGH QUALITY CABLE SLABS/TILES (SINGLE HOOK)

(Thickness: 2mm)

| Item Code | Size (mm) | Colour |
|---|----------------------------------|-----------|
| DSSB-CSAP-100C-1 | 100mm (W) x 1000mm(L) x 2mm(T) | Customize |
| DSSB-CSAP-150G-1 | 150mm (W) x 1000mm(L) x 2mm(T) | Green |
| DSSB-CSAP-200Y-1 | 200mm (W) x 1000mm(L) x 2mm(T) | Yellow |
| DSSB-CSAP250Y-1GSM | 250mm (W) x 1000mm (L) x 2mm (T) | Yellow |
| DSSB-CSAP250O-1 | 250mm(W) x 1000mm (L) x 2mm (T) | Orange |
| DSSB-CSAP250G-1 | 250mm(W) x 1000mm (L) x 2mm (T) | Green |
| Other size/colour please call for enquiry | | |



ANGLE PLATE TYPE
DOUBLE RIB



*Now you can customize
your own colour &
wordings!!!
Call: +603- 9282 4007*

BS EN 12613:2009

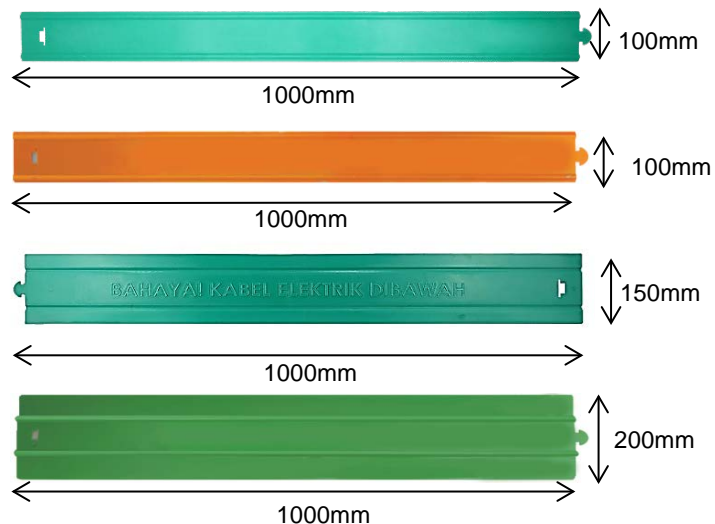



Redefining Supply
An ISO 9001:2015 &
14001:2015 Company

DELTA SAMA JAYA SDN. BHD. (DSSB) (Reg. No: 500276-W)

No. 23G & 23M, DSSB Building, Jalan Perdana 6/8, Pandan Perdana,
55300 Kuala Lumpur, Malaysia

Tel: +603-92824007, +603-92813778 Fax: +603-92870705

Email: (HQ): samajaya@substation.com.my, (Sales): sales@substation.com.my

Website: www.substation.com.my, www.cablecleat.com.my



HIGH QUALITY CONCRETE CABLE SLAB / TILES

(11kV, 33kV, 132kV and 275kV)

| Item No. | Item Code | Size | Weight (kg) |
|----------|-------------------|-----------------------|-------------|
| 1 | DSSB-CSM-CCS150C | 150mm X 1000mm X 50mm | 15 |
| 2 | DSSB-CSM-CCS300CC | 300mm X 1000mm X 50mm | 36 |
| 3 | DSSB-CSM-CCS150C | 150mm X 1000mm X 50mm | 15 |
| 4 | DSSB-CSM-CCS300CS | 300mm X 610mm X 50mm | 22 |
| 5 | DSSB-CSM-CCS280C | 280mm X 900mm X 50mm | 29 |
| 6 | DSSB-CSM-CCS345C | 345mm X 840mm X 50mm | 27 |
| 7 | DSSB-CSM-CCS150C | 150mm X 900mm X 50mm | 14 |
| 8 | DSSB-CSM-CCS350C | 350mm X 870mm X 65mm | 39 |
| 9 | DSSB-CSM-CCS150C | 150mm X 900mm X 50mm | 13 |
| 10 | DSSB-CSM-CCS150C | 150mm X 900mm X 50mm | 13 |

Other wording are available upon request



Item 1



Item 2



Item 3



Item 4



Item 5

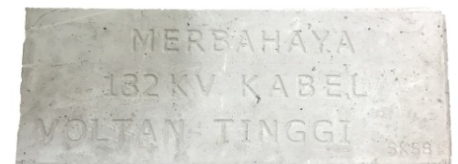

Item 6



Item 7



Item 8



Item 9



Item 10



Redefining Supply
An ISO 9001:2015 &
14001:2015 Company

DELTA SAMA JAYA SDN. BHD. (DSSB) (Reg. No: 500276-W)

No. 23G & 23M, DSSB Building, Jalan Perdana 6/8, Pandan Perdana,
55300 Kuala Lumpur, Malaysia

Tel: +603-92824007, +603-92813778 Fax: +603-92870705

Email: (HQ): samajaya@substation.com.my, (Sales): sales@substation.com.my

Website: www.substation.com.my, www.cablecleat.com.my



HYBRID CONCRETE CABLE SLAB

| Item Code | Size | Weight (kg) |
|-------------------|-----------------------|-------------|
| DSSB-CSM-CPCS300C | 300mm X 1000mm X 50mm | 36kg |

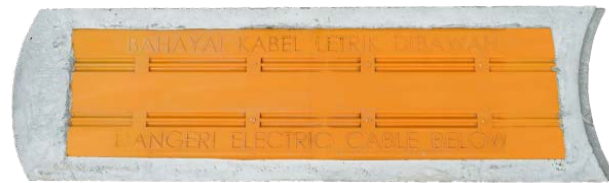



Redefining Supply
An ISO 9001:2015 &
14001:2015 Company

DELTA SAMA JAYA SDN. BHD. (DSSB) (Reg. No: 500276-W)

No. 23G & 23M, DSSB Building, Jalan Perdana 6/8, Pandan Perdana,
55300 Kuala Lumpur, Malaysia

Tel: +603-92824007, +603-92813778 Fax: +603-92870705

Email: (HQ): samajaya@substation.com.my, (Sales): sales@substation.com.my

Website: www.substation.com.my, www.cablecleat.com.my



HIGH QUALITY CONCRETE CABLE MARKER

(Square)

| Item No. | Item Code | Size | | | Weight |
|----------|------------------|---------|------------|----------|--------|
| | | A (top) | B (height) | C (base) | |
| 1 | DSSB-CSM-CCMS300 | 125mm x | 300mm x | 175mm | 15 kg |
| 2 | DSSB-CSM-CCMS400 | 100mm x | 400mm x | 150mm | 18 kg |
| 3 | DSSB-CSM-CCMS400 | 100mm x | 400mm x | 150mm | 13 kg |

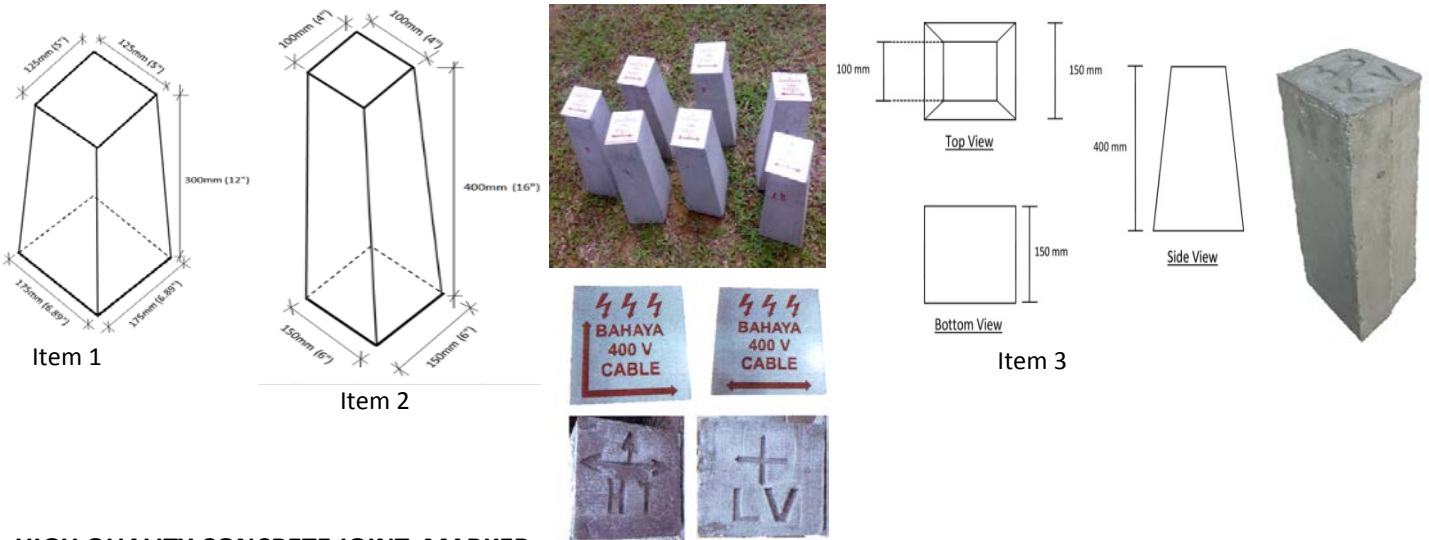

HIGH QUALITY CONCRETE JOINT MARKER

| Item No. | Item Code | Size | | | Weight (kg) |
|----------|-----------------|---------|------------|----------|-------------|
| | | A(top) | B (height) | C (base) | |
| 1 | DSSB-CSM-CJM781 | 194mm x | 781mm x | B375mm | 32 |
| 2 | DSSB-CSM-CJM200 | 200mm x | 700mm x | 85mm | 24 |

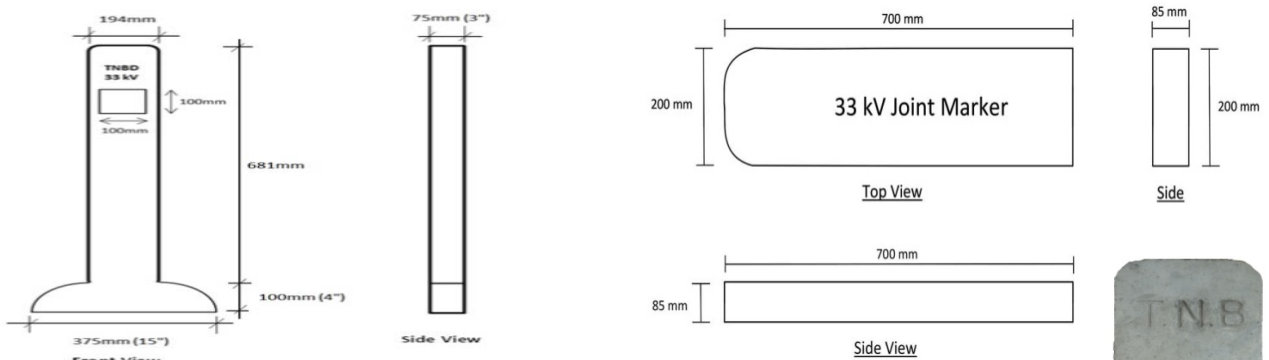

Item 1



Item 2



PHOTOS



HIGH QUALITY PLASTIC CABLE SLAB / TILES



DELTA SAMA JAYA SDN. BHD. (DSSB) (Reg. No: 500276-W)

No. 23G & 23M, DSSB Building, Jalan Perdana 6/8, Pandan Perdana,
55300 Kuala Lumpur, Malaysia

Tel: +603-92824007, +603-92813778 Fax: +603-92870705

Email: (HQ): samajaya@substation.com.my, (Sales): sales@substation.com.my

Website: www.substation.com.my, www.cablecleat.com.my



Redefining Supply
An ISO 9001:2015 &
14001:2015 Company

PENGERANG RAPID PROJECT: HIGH QUALITY CABLE SLAB/ TILES (INSTALLATION WORKS)



PHOTOS



HIGH QUALITY CONCRETE CABLE SLAB / TILES



Redefining Supply
An ISO 9001:2015 &
14001:2015 Company

DELTA SAMA JAYA SDN. BHD. (DSSB) (Reg. No: 500276-W)

No. 23G & 23M, DSSB Building, Jalan Perdana 6/8, Pandan Perdana,
55300 Kuala Lumpur, Malaysia

Tel: +603-92824007, +603-92813778 Fax: +603-92870705

Email: (HQ): samajaya@substation.com.my, (Sales): sales@substation.com.my

Website: www.substation.com.my, www.cablecleat.com.my



CONCRETE CABLE SLAB / TILES INSTALLATION WORKS

- 1) Workers moving concrete cable slab / tiles into the location.
- 2) Ready for Installation.
- 3) Installation Complete.
- 4) Sand is used to cover the cable slab.





Redefining Supply
 An ISO 9001:2015 &
 14001:2015 Company

DELTA SAMA JAYA SDN. BHD. (DSSB) (Reg. No: 500276-W)

No. 23G & 23M, DSSB Building, Jalan Perdana 6/8, Pandan Perdana,
 55300 Kuala Lumpur, Malaysia

Tel: +603-92824007, +603-92813778 Fax: +603-92870705

Email: (HQ): samajaya@substation.com.my, (Sales): sales@substation.com.my

Website: www.substation.com.my, www.cablecleat.com.my

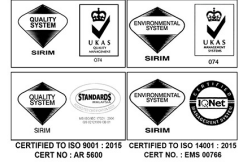

CONCRETE CABLE SLAB / TILES INSTALLATION WORKS

Concrete Cable Slab / Tiles during relocation of underground power cables for MRT project in IKEA / One Utama Area.





Redefining Supply
An ISO 9001:2015 &
14001:2015 Company

DELTA SAMA JAYA SDN. BHD. (DSSB) (Reg. No: 500276-W)

No. 23G & 23M, DSSB Building, Jalan Perdana 6/8, Pandan Perdana,
55300 Kuala Lumpur, Malaysia

Tel: +603-92824007, +603-92813778 Fax: +603-92870705

Email: (HQ): samajaya@substation.com.my, (Sales): sales@substation.com.my

Website: www.substation.com.my, www.cablecleat.com.my



INSTALLATION REFERENCE LIST

**PLEASE CONTACT US FOR
INSTALLATION REFERENCE LIST
FOR
HIGH QUALITY PLASTIC CABLE SLAB
&
HIGH QUALITY CONCRETE CABLE SLAB**

CABLE CLEATS & CABLE SLABS

DATE : 15/01/2018

RoHS COMPLIANCE STATEMENT

EU-directive one substance restrictions (RoHS-Directive 2011/65/EU)

RoHS Directive 2011/65/EU has the restriction of the use of certain hazardous substances as their aim.

To this end, maximum values were specified for these substances.

The substances affected are:

- Lead, mercury, hexavalent chromium, polybrominated biphenyl (PBB), polybrominated diphenyl ether (PBCE) – a maximum of 0.1% by weight is permissible for these substances
- Cadmium- a maximum of 0.01% by weight is permissible for this substance

We confirm that our products in Cable Cleats & High-Quality Plastic Slabs are manufactured according to the actual version of RoHS-Directive 2011/65/EU.

Delta Sama Jaya Sdn.Bhd.



We are constantly reviewing and updating our products,
for the latest information please call us on (+603) 9281 3778
or visit our website at: www.substation.com.my